

LEGEND

#	PORTABLE		SCHOOL BUS
R#	PORTABLE RESTROOM		SAWCUT
			DOMESTIC WATER SERVICE
			WATER VALVE

CONSTRUCTION KEY NOTES

- 1 REPLACE ASPHALT IN KIND FOR TRENCH CUT AT EXISTING LINE AND GRADE.
- 2 REPLACE CONCRETE IN KIND FOR TRENCH CUT AT EXISTING LINE AND GRADE. REMOVE ENTIRE PANEL AND CENTER WATERLINE WITHIN PANEL.
- 3 INSTALL 4" STRIPING.
- 4 INSTALL 8" STRIPING FOR CROSSWALK.
- 5 INSTALL TRANSVERSE MEDIAN BARS STRIPING.
- 6 INSTALL STRAIGHT ARROW SYMBOL.

WATER SYSTEM KEY NOTES

- 1 INSTALL 1/2" PEX PIPE AT LENGTH SHOWN. SEE TRENCH DETAIL, THIS SHEET.
- 2 HOT TAP EXISTING 6" WATER MAIN. INSTALL WITH VALVE BOX.
- 3 DOMESTIC WATER POINT OF CONNECTION TO BUILDING.

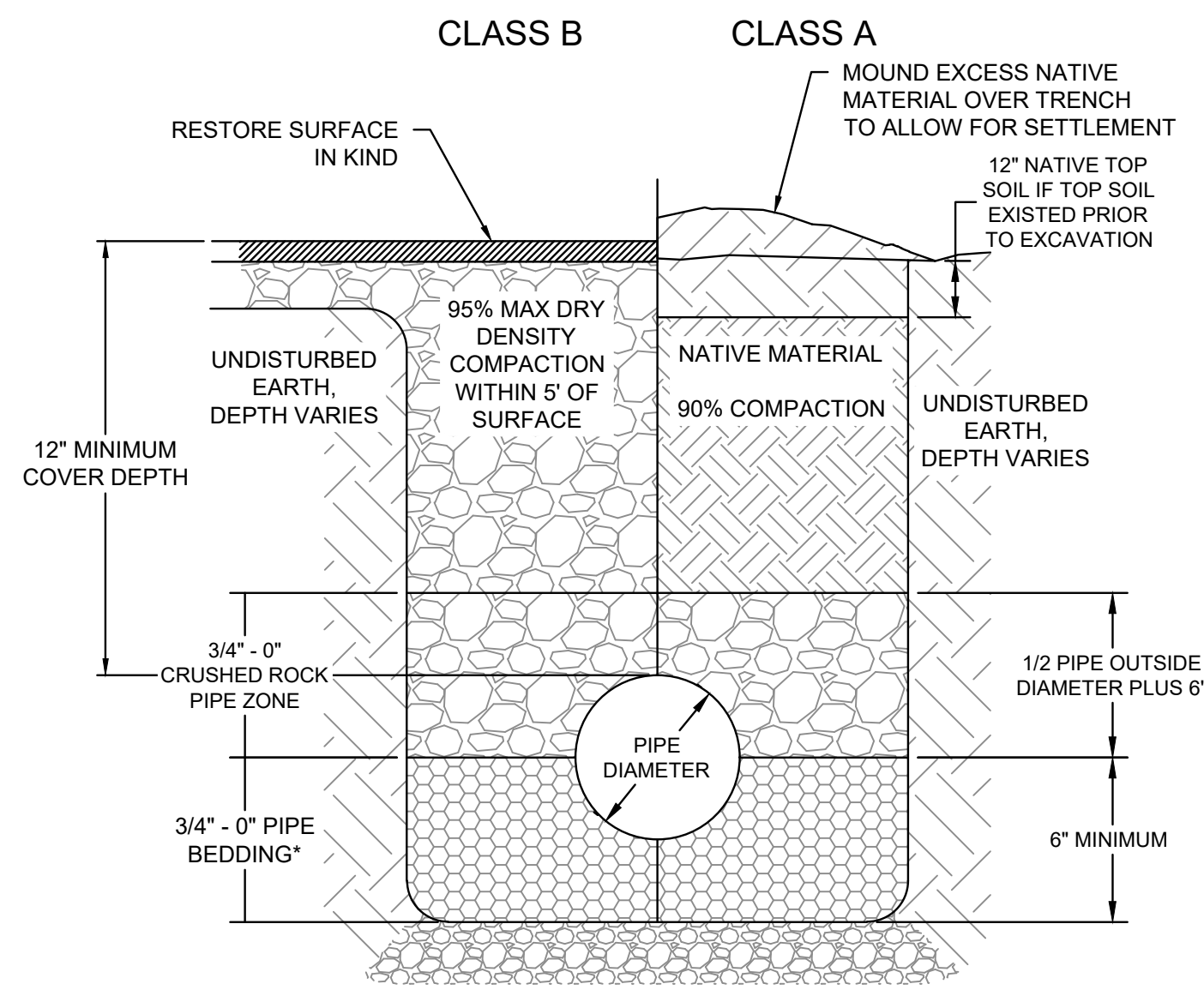

GENERAL NOTES:

1. IF REQUIRED, TRENCH STABILIZATION SHALL BE SPECIFIED SEPARATELY AND PLACED PRIOR TO PLACEMENT OF BEDDING MATERIAL.
2. ALL COMPACTION REQUIREMENTS PER ASTM D698.

TRENCH BACKFILL DETAIL
NTS

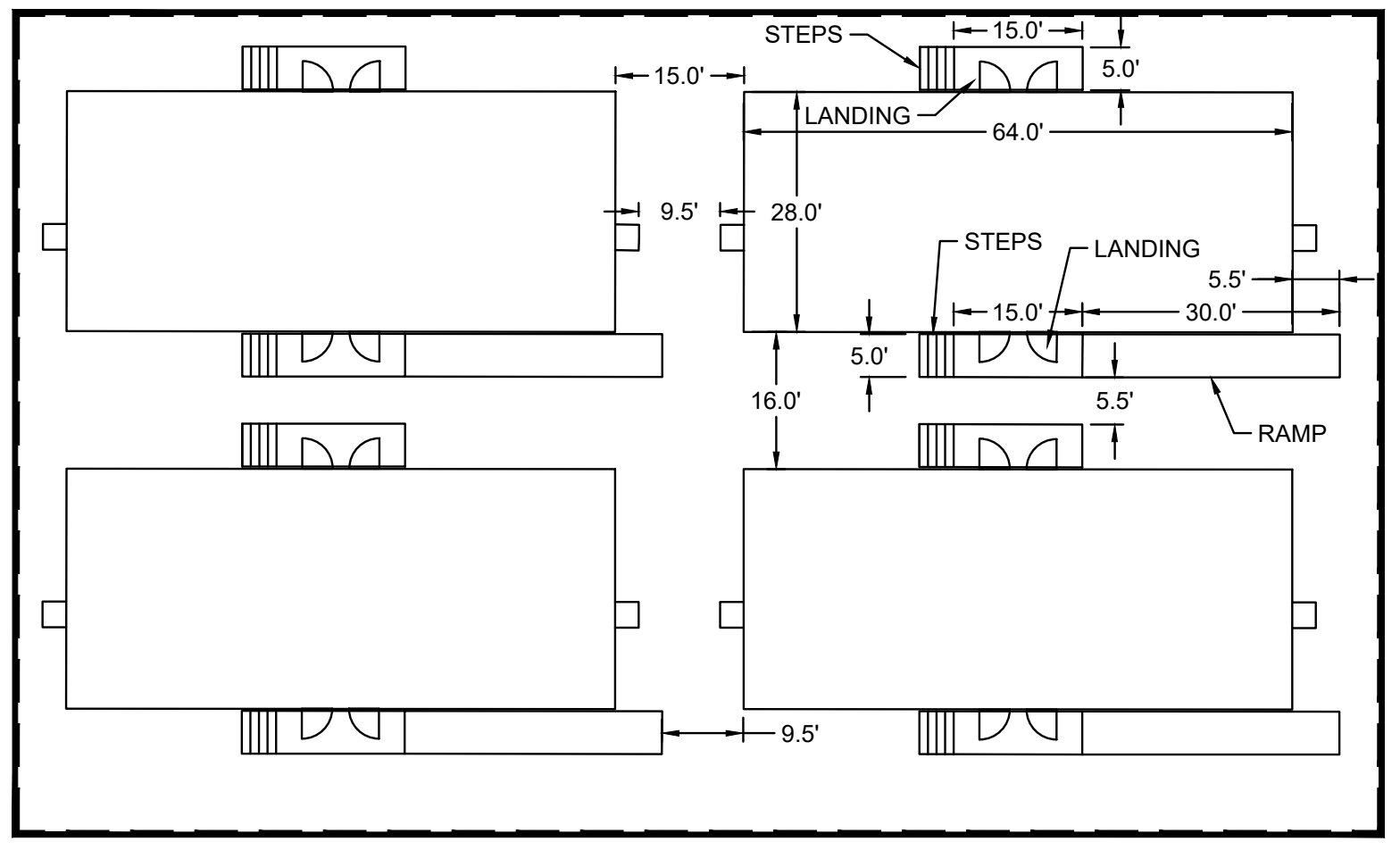

TYPICAL PORTABLE LAYOUT DETAIL
SCALE: 1" = 20'

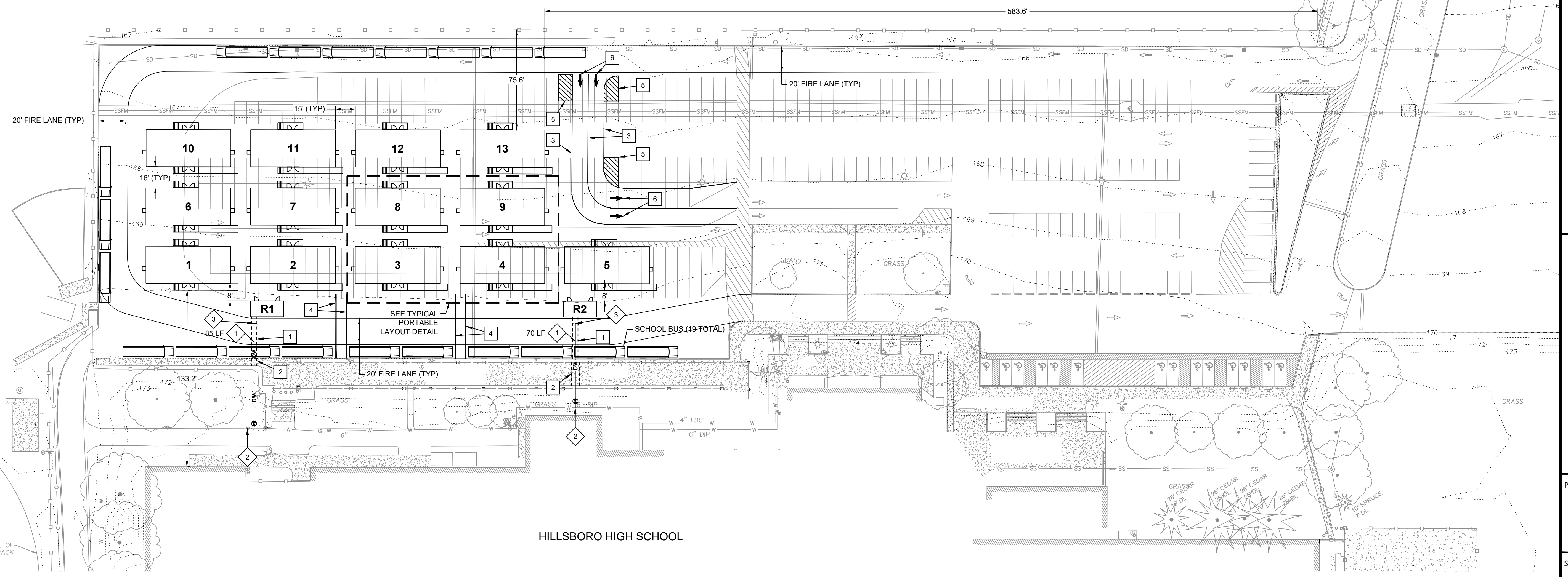

HILLSBORO HIGH SCHOOL

SITE & UTILITY PLAN
HILLSBORO HIGH SCHOOL
HILLSBORO SCHOOL DISTRICT
 3825 SE ROOD BRIDGE ROAD
 HILLSBORO, OR 97123

3J CONSULTING
 CIVIL ENGINEERING
 WATER RESOURCES
 COMMUNITY PLANNING

5075 SW GRIFFITH DRIVE, SUITE 150, BEAVERTON, OR 97005

PROJECT INFORMATION
 3J PROJECT # | 18485.20
 TAX LOT(S) | 1S2080000900/1000
 LAND USE # |
 DESIGNED BY | ARD
 CHECKED BY | JDH

SHEET NUMBER
C200

P:\18485-HSD-HILLSBORO-HS\CAD\200\C200-SITE PLAN.DWG